

KENT

3 in 1

MINI BLENDER
& FOOD CHOPPER

KENT

Smart Chef

Appliances

HOUSE of PURITY

Instruction Manual

HIGH SPEED OPERATION
22000 RPM



Chutney Jar



Chopping Bowl



Interchangeable Motor



Juice Bottle
With Vacuum Lid
(Optional Purchase)

Welcome to KENT

Dear Customer,

Congratulation on your purchase and welcome to **KENT**.

At the outset, allow us to thank you for your trust in **KENT Smart Chef Appliances**. At KENT, we take pride in our reputation for quality products and industry proven performance. We are certain that you will be more than satisfied with **KENT 3-In-1 Mini Blender & Food Chopper's** performance and that it will serve you and your family without any compromise.

This guide will help you in getting the best out of your appliance. Please go through the booklet to familiarize yourself with its operation and maintenance.

With the robust build and high quality, you can look forward to years of trouble free service.

To ensure that the warranty of your appliance is effective, it is important that you fill up the enclosed warranty card and mail it to us within 15 days of purchase.

In case you require any further information, please contact your nearest **KENT** dealer / branch.

Bon Appétit!

KENT RO Systems Ltd.

TABLE OF CONTENTS

1. Introduction	1
2. Features of KENT 3-In-1 Mini Blender & Food Chopper	1
3. Know Your Product	1
4. Items in the Box.....	2
5. Using KENT 3-In-1 Mini Blender & Food Chopper	2
6. Operating Modes	2
7. How to Operate	3
8. Cleaning and Maintenance	4
9. Precautions.....	4
10. Important Safety Instructions	4
11. Troubleshooting.....	5
12. Technical Specifications	6

INTRODUCTION

We, at KENT, have always believed that a clean and healthy life is the right of every individual. This ethos is what made us embark on the journey to develop innovative solutions for purifying the water that we drink, vegetables and fruits that we eat, homes that we live in and the air that we breathe.

Use of innovative technology and support from a competent service network have enabled us to create a brand, which has become synonymous to well-being and health. Continuing with the tradition, we now present the **KENT 3-In-1 Mini Blender & Food Chopper**, a new age, high-speed portable blender that works like magic.

KENT 3-In-1 Mini Blender & Food Chopper is not your ordinary kitchen appliance. It's designed to save time so that you are done with your kitchen chores in a matter of minutes. Unlike bulky blenders and unwieldy food processors that most of us only pull out of storage for specific recipes and special occasions, KENT 3-In-1 Mini Blender & Food Chopper is so handy, so versatile and so easy to use that you'll put it to work every single day.

FEATURES OF KENT 3-IN-1 MINI BLENDER & FOOD CHOPPER

- Portable multi-functional - blender, grinder and food chopper
- High speed operation, runs at 22000 rpm
- 3-In-1: chops, grinds and makes juice
- Minces meat and chops vegetables as well
- Prepares purees, chutney, shakes and juices
- Blade made from high carbon stainless steel for high durability & life
- The juice bottle comes with the lid to store the juice for later use
- Versatile and easy to use

KNOW YOUR PRODUCT

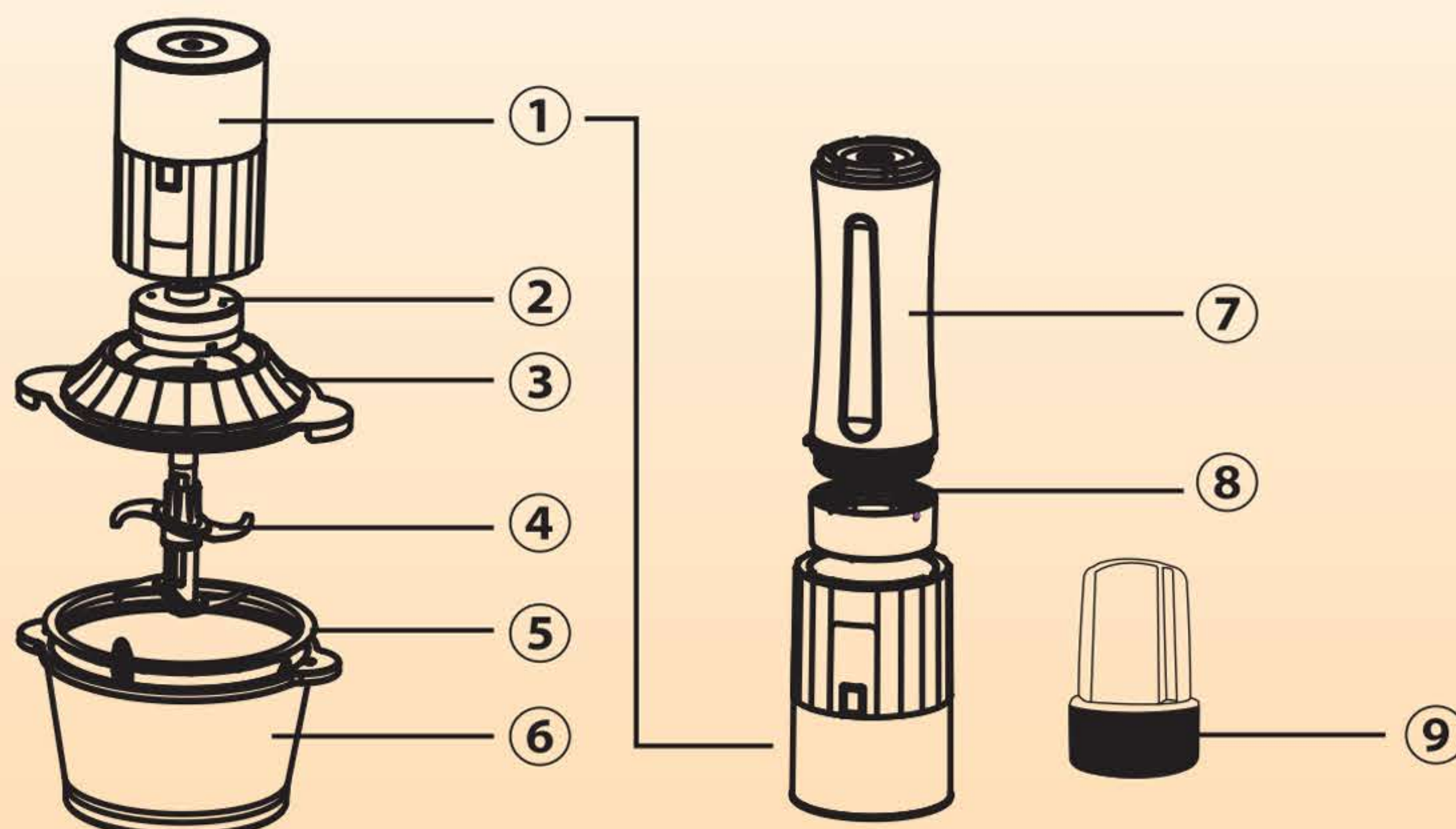

1. Interchangeable motor
2. Transmission
3. Bowl cover
4. Chopper blades assembly
5. Overflow ring
6. Chopping bowl
7. Juice bottle
8. Juicer blade assembly
9. Grinding jar

ITEMS IN THE BOX

1. KENT 3-In-1 Mini Blender & Food Chopper : 01 No.
2. Juicer bottle : 01 No.
3. Chopping bowl : 01 No.
4. Grinder jar : 01 No.
5. User guide : 01 No.

USING KENT 3-IN-1 MINI BLENDER & FOOD CHOPPER

1. Remove any stickers that might prevent from operating the unit.
2. Check the unit for damages. Do not use in case of any damages.
3. Before switching on the appliance, make sure that your home mains voltage corresponds to the unit's operating voltage.
4. Clean the parts of the KENT 3-In-1 Mini Blender & Food Chopper before using the appliance for the first time (see 'Cleaning & Maintenance' section).
5. Make sure all parts are completely dry before you start using the appliance.

OPERATING MODES

		
CHOPPING MODE	JUICER MODE	GRINDING MODE
Ideal for: <ul style="list-style-type: none">• Mincing meat• Vegetables	Ideal for: <ul style="list-style-type: none">• Purees• Milk shakes• Shakes• Juices	Ideal for: <ul style="list-style-type: none">• Cereals• Chutney

HOW TO OPERATE

Chopping Mode

1. Clean the parts before using the appliance.
2. Mount the chopping blades on the bowl.
3. Fill in the ingredients in the chopping bowl.
4. Close with lid and place the transmission in correct position.
5. Mount the motor on the chopping jar. Ensure that it sits correctly.
6. Switch-on.

Juicer Mode

1. Un-lid the juicer bottle and add the ingredients in the bottle
2. Add milk or water as per the taste or requirement
3. Secure the juicer blade assembly tightly in place on the bottle
4. Turn the bottle upside down and place it on the motor base unit
5. Turn the appliance on
6. Once done, switch off the appliance and unmount the bottle.
7. Replace the juicer blade assembly with a normal lid and keep in fridge for later use.

Optional Purchase: A vacuum lid with bottle can be purchased separately to keep the juice fresh for a longer time

Benefits of Vacuum Lid: Juices when exposed to air gets oxidized, leading to loss of minerals and fibres. The vacuum lid prevents oxidation and keeps the juices fresh for a longer time.

How to Use:

- Put the vacuum lid on the bottle filled with fresh juice.
- Pull the top lever repeatedly till vacuum is created
- Store in fridge for later consumption
- To open the bottle, push the slide button (on the side of the cap) up. This would release the vacuum seal
- Un-lid and pour juice

Grinding Mode

1. Unlid the grinding jar and add the ingredients.
2. Secure the lid tightly.
3. Turn the jar upside down and place on the motor base kept on a firm place.
4. Switch – on.
5. Once done, switch-off the appliance. Turn counter clockwise and unmount the grinding jar.

CLEANING & MAINTENANCE

- Switch off and unplug the appliance before cleaning it
- Remove the lid and clean the jar with a solution of lukewarm water & soap
Use a cleaning brush, never use scouring pads to clean it
- Wipe the main unit with a moist cloth and a non-abrasive liquid cleaner
- Do not immerse the appliance in water or any other liquid
- Never put any part of the appliance in the dishwasher
- After cleaning it thoroughly, dry it using a soft cloth
- Ensure that the appliance is completely dry before storing it

Note: Never immerse the motor unit of the blender in water, nor rinse it under the tap. Wipe it with a dry cloth.

PRECAUTIONS

- Do not disassemble, repair or alter the appliance on your own.
It may cause appliance failure or breakdown
- The input voltage must not exceed the rating, it might damage the appliance
- Unplug before cleaning / moving the appliance
- Do not use the appliance with a damaged power cord or plug
- Do not use the appliance near any heat source
- If the appliance is not in use for a longer time, unplug it
- Do not use the appliance when it is in a recumbent or inclined position

IMPORTANT SAFETY INSTRUCTIONS

When using an electrical appliance, basic precautions should always be followed, including the following:

1. Unplug, when not in use and before servicing.
2. To reduce the risk of an electric shock, do not use near or on wet surfaces.
3. Use the appliance only as described in the manual.
4. Do not use the appliance if cord or plug is damaged or worn out. Replace the damaged cord or plug immediately.
5. Do not try to service the appliance on your own. Send it to an authorized service center only.
6. Keep cord away from heated surfaces.
7. Do not unplug the appliance by pulling the cord. Always unplug by pulling the plug.
8. To avoid electric shocks, do not use the appliance with wet hands.

9. Keep hair, loose clothing, fingers and all parts of body away from moving parts.
10. Turn all controls off before unplugging.
11. This appliance is suitable for indoor use only.
12. Keep away from children.

TROUBLESHOOTING

PROBLEM	POSSIBLE CAUSE	POSSIBLE SOLUTION
The appliance does not start.	There is a connection problem.	Check if the appliance is connected to the mains and if the plug is inserted firmly into the wall socket.
	The appliance is defective.	Switch off the appliance and unplug it. Go to the nearest KENT authorized service centre for assistance
The appliance suddenly stops working while running.	The appliance has overheated.	Let the appliance cool for 20 minutes before attempting to restart it.
	The appliance is over loaded.	Remove some ingredients, add some water and try again.
	The appliance is defective.	Switch off the appliance and unplug it. Go to the nearest KENT authorised service centre for assistance.
The appliance makes lots of noise.	Jar is not placed properly.	Reposition the jar in the correct position.
	Blades not working properly.	Reinstall the blades correctly. If problem persists, replace blades.
	Problem with blender's inner drive broken.	Switch off the appliance and unplug it. Go to the nearest KENT authorized service centre for assistance.
Motor does not work properly.	Appliance is defective.	Switch off the appliance and unplug it. Go to the nearest KENT authorised service centre for assistance.
	Blades are not installed properly.	Reinstall the blades correctly. If problem persists, replace blades.

TECHNICAL SPECIFICATIONS

Model Name	KENT 3-In-1 Mini Blender & Food Chopper
Model Number	16028
Net Weight	1.64 kg
Chopper Bowl Capacity	1800 ml
Chopper Bowl Dimension (mm)	140 (D) X 210 (H)
Juice Jar Capacity	600 ml
Juice Jar Dimension (mm)	73.5 (D) x 230 (H)
Grinder Jar Capacity	100g
Grinder Jar Dimension (mm)	78 (D) x 108 (H)
Input Power Supply	Single Phase 220 V, AC 50 Hz.
Total Power Consumption	300 W
Speed	22000 rpm
Noise	<= 80 db



HOUSE of PURITY



Innovations for
Better Living

Imported & Marketed by:
KENT RO SYSTEMS LTD.
A-6, Sector-87, Noida-201301

For customer complaints, contact our Customer Care Officer at:
E-6, 7 & 8, Sector-59, Noida, U.P.-201 309, India. Call: 092-789-12345
E-mail: service@kent.co.in or visit us at www.kent.co.in